

Die-Cast  
Zinc Alloy

# Washer Based Open-End Cap

# Nuts

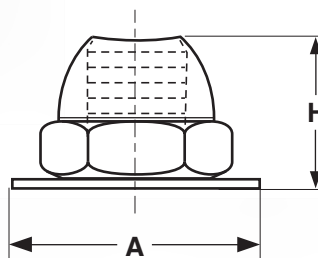
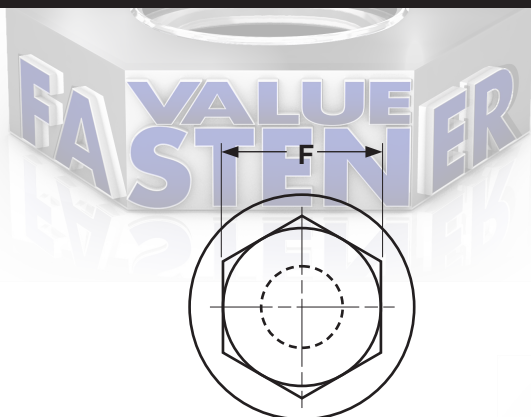

WASHER-BASED OPEN-END CAP NUTS							
Nominal Size or Basic Thread Diameter		F		N		R	
		Width Across the Flats		Overall Height		Washer Base Diameter	
		Max	Min	Max	Min	Max	Min
10	0.1900	0.375	0.362	0.291	0.271	0.450	0.430
1/4	0.2500	0.438	0.423	0.338	0.318	0.522	0.502
5/16	0.3125	0.562	0.545	0.385	0.365	0.667	0.647
3/8	0.3750	0.625	0.607	0.431	0.411	0.739	0.719

<b>Description</b>	A zinc alloy internally threaded fastener that features a wide-diameter, integral washer base and a low-crown cap with the top portion of its dome removed.
<b>Applications / Advantages</b>	This design is preferred by some as a more attractive alternative to a basic hex nut. It is a useful alternative to a washer-based closed-end cap nut because it can be used with bolts of any length. Washer-base design enables the nut to be used in oversized or offset holes, and with soft services such as wood or plastic.
<b>Material</b>	Nuts are made from the zinc die cast alloy Zamak #3 which conforms to the following chemical composition requirements-- <b>Aluminum:</b> 3.5-4.3%; <b>Magnesium:</b> 0.02-0.05%; <b>Copper:</b> 0.25%* max.; <b>Iron:</b> 0.10% max.; <b>Lead:</b> 0.005% max.; <b>Cadmium:</b> 0.004% max.; <b>Tin:</b> 0.003% max.; <b>Zinc:</b> balance (*Note: Most commercial applications will accept copper content within the range of 0.25-0.75% without rejecting the product).